



printer-copier

Powerful performance.
Professional colour.



DocuColor® 240/250

Performance at its best

Flexible Device Interface!

- Large, full-colour touch-screen is easy to use and simple to programme.
- Customise the keypad with the features you use most, such as Network Scanning or stored programs.
- So intuitive, copying and printing are easier than ever.

With its high performance features, this device enables you to take on more jobs, more often.

- Select the DocuColor 240 printer-copier for swift job completion at up to 40 ppm colour and up to 55 ppm black and white. For even greater performance, select the DocuColor 250 printer-copier for up to an amazing 50 ppm colour and 65 ppm black and white. The choice is yours.
- Your first page comes out in as fast as 7.8 seconds in colour (4.3 seconds in black and white) – great for single-page jobs.
- Out of toner? Don't worry. You can load a fresh toner cartridge even while you're printing – without interrupting the job in progress.
- Choose from a selection of powerful controllers for maximum productivity.
- Enjoy sharp images with outstanding fine lines and shadow detail, thanks to Emulsion Aggregation (EA) High Gloss toner.



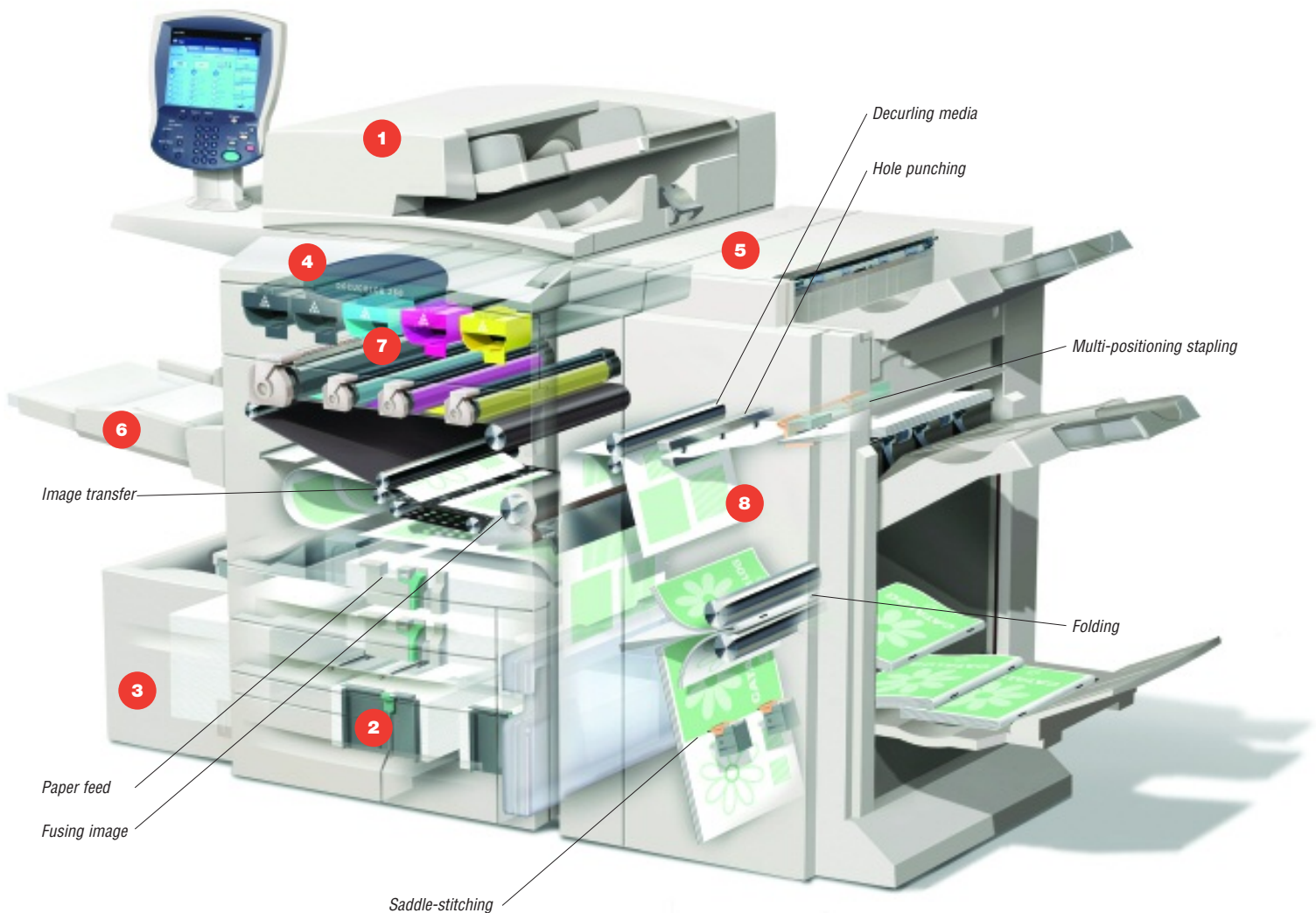

Features

- 1** 250-sheet Duplex Automatic Document Feeder (DADF) simplifies the copying and scanning of large jobs.
- 2** 5 standard trays have a total paper capacity of 3,260! Plus, trays one and two can handle custom media. You can devote an entire tray to the speciality media you use most.
- 3** A choice of optional high-capacity feeders for those long job runs. Sheet size up to SRA3. Just load and go.
- 4** Increased toner capacity. Two black toner SMart Kit™ replaceable units keep replenishment interventions to a minimum and productivity to a maximum.
- 5** Optional finishers (Professional Finisher shown) add the final touches to professional documents.
- 6** A short, straight paper path prevents jams while providing heavier media feeding capability and increased reliability. Centre registered feeding results in accurate registration and less paper skew.
- 7** Trickle charge development system – unique to Xerox – maintains print consistency all day long. You never have to do a quality check at the eleventh hour.
- 8** New 2400 dpi resolution delivers excellent image clarity in both prints and copies. Plus, the device employs the new Charge Corotron Cleaning Assembly to maintain consistently brilliant image quality.

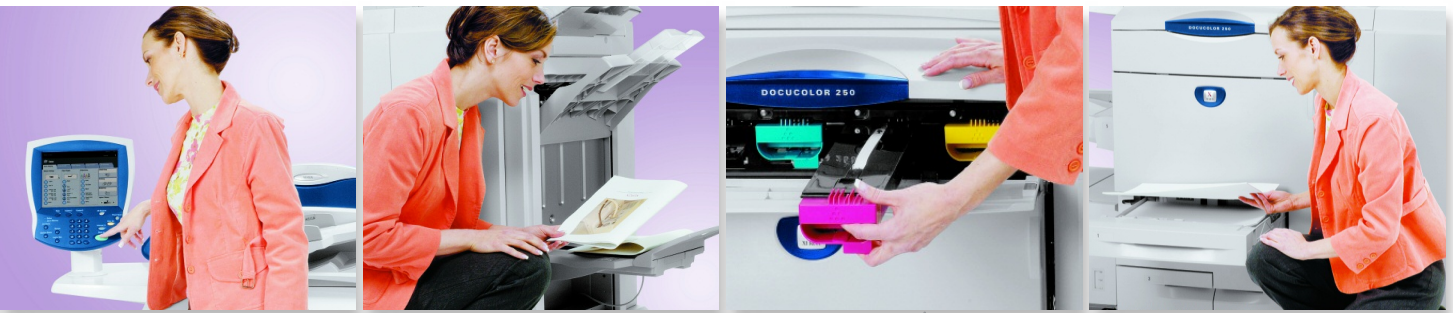

Scalable to your needs

The DocuColor 240/250 printer-copier is so flexible, you can tailor it to your specific environment.

- Enjoy a selection of world-class controllers for unmatched speeds, colour management tools and extraordinary image quality. Choose the controller that best matches your workflow.
- Have a lot of large document sets to print or copy? Add on a high-capacity feeder for maximum paper capacity.
- Turn desktop publishing into desktop production with our fantastic finishers:



Sort and collate



Stapling



Hole punch



Folding



Booklet

Advanced Finisher: offers 50-sheet multi-position stapling and hole punching, plus stacking of up to 3,000 sheets.

Professional Finisher: provides saddle-stitched booklet making, V-fold brochure assembly, stapling and hole punching.



Colour your world wonderfully

Nothing looks better than Xerox colour. With our colour tools, your output will always exceed expectations.

- Enjoy razor-sharp printing and copying at 2400 x 2400 dpi. This high level of resolution delivers excellent fine line reproduction and outstanding shadow details.
- For jobs that require a high-gloss finish, Enhanced Gloss mode makes prints jump off the page. What's more, you can select the level of gloss you want for each job.
- Precise print and copy calibration guarantees professional colour results.
- Profiling options enable you to emulate different output devices. This way you can see what your document will look like at each printing stage. It makes proofing easy and eliminates surprises in the production phase.
- Prints perfectly on a wide range of media (up to 300 gsm).



Speed, colour, value, amazement

For fast, affordable colour and brilliant image quality, look no further than the DocuColor 240/250 printer-copier. It's *the* choice for colour-intensive environments. Whether you're a graphic artist or you run the print department, this scalable solution gives you the tools you need for the colour you expect.



Discover what the DocuColor 240/250 can offer you

Demanding Office Environments

Quick turnaround times and great quality for reports, presentations, letterhead and newsletters make it an ideal solution for busy workgroups.

Centralised Reproduction Departments

Quick completion times for copies, prints and reprints, plus a selection of print workflow options make this the right choice for fast-paced centralised reproduction departments.

Pay for Print

Ease of use, low acquisition and running costs, and a small footprint suit a pay-for-print environment perfectly.

Creative Professionals

Brilliant, accurate colour, outstanding colour management tools and proofing options make it ideal for those in graphic communications.

Commercial Printers

Fast, high-quality outputs and a seamless fit with existing print workflows make it perfect for commercial printers.

DocuColor® 240/250

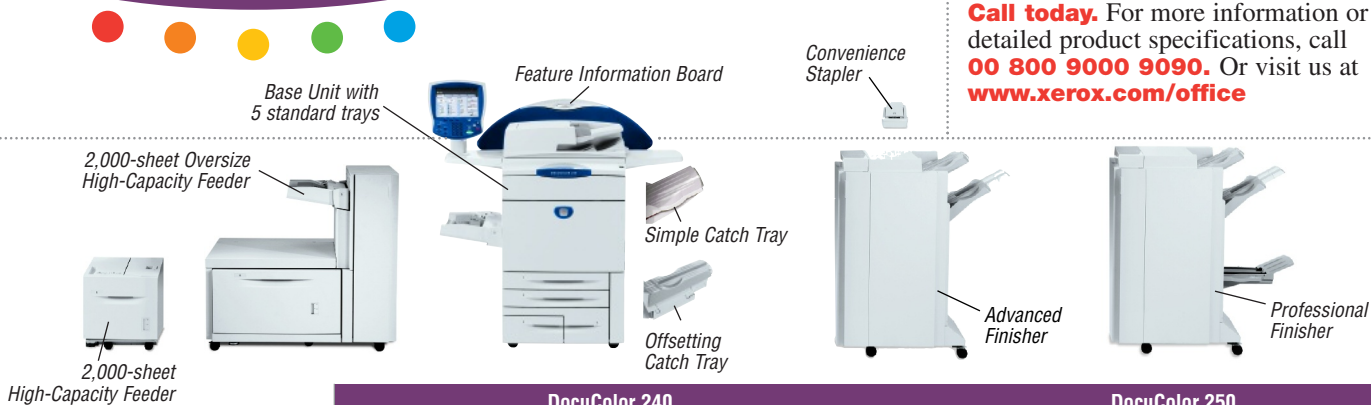

Call today. For more information or detailed product specifications, call **00 800 9000 9090**. Or visit us at **www.xerox.com/office**

	DocuColor 240	DocuColor 250
Speed (Colour / Black and White)	Up to 40 ppm / 55 ppm	Up to 50 ppm / 65 ppm
Duty Cycle*	Up to 200,000 pages per month	Up to 200,000 pages per month
Average Monthly Print Volume**	10,000 to 40,000 pages per month	
Paper Handling	250-sheet Bypass Tray; Two 500-sheet A3 Paper Trays; One 870-sheet A4 Paper Tray; One 1,140-sheet A4 Paper Tray (Total 3,260 sheets)	
Paper input	Standard	2,000-sheet High-Capacity Feeder (A4) 2,000-sheet Oversize High-Capacity Feeder (SRA3)
	Optional	
Paper output	Optional	Simple Catch Tray (SCT) Offsetting Catch Tray (OCT) Advanced Finisher: 500-sheet top tray, 3,000-sheet stacker tray, hole punching and multi-position stapling Professional Finisher: 500-sheet top tray, 1,500-sheet stacker tray, hole punching, multi-position stapling, V-fold booklet making, saddle-stitch booklet maker
Copy	256 MB plus 80 GB hard disk drive	
Pre-collation memory	As fast as 7.8 seconds colour / 4.3 seconds black and white	
First-page-out time	2400 x 2400 dpi	
Copy Resolution	Reduction / enlargement (25% – 400%), Enhanced gloss level, Book copying / two-sided book copying, Mixed-sized originals, Image rotation, Edge erase, Mirror / Negative images, Image shift, Booklet creation, Multi-Up, Annotation and set numbering, Covers, Poster mode, Repeat Image, Build Job, Delete inside/Outside editing	
Copy Features	2400 x 2400 dpi	
Print	2400 x 2400 dpi	
Print Resolution	200 x 200 dpi, 300 x 300 dpi, 400 x 400 dpi, 600 x 600 dpi	
Scan	Foreign Interface Kit, Feature Information Board, Convenience Stapler	
Scan Resolution		
Other Options		

SPECIFICATIONS

Speed

Warm-up Time

From Sleep Mode: 150 seconds (approx.)

From Low Power Mode: 30 seconds (approx.)

Scan Speed with DADF (A4):

50 ppm Colour

80 ppm Black and White

DocuColor 250 Speed by Media (A4 LEF)

Type	Mode	ppm colour / bw
Plain paper	Plain	50 / 65
Plain paper	Enhanced Gloss	25 / NA
105 – 176 gsm	Heavyweight 1	25 / 65
105 – 176 gsm	Enhanced Gloss	16 / NA
177 – 300 gsm	Heavyweight 2	16 / 40
Transparency	Transparency	16 / 40

(Requires a finisher)

DocuColor 240 Speed by Media (A4 LEF)

Type	Mode	ppm colour / bw
Plain paper	Plain	40 / 55
Plain paper	Enhanced Gloss	22 / NA
105 – 176 gsm	Heavyweight 1	22 / 55
105 – 176 gsm	Enhanced Gloss	15 / NA
177 – 300 gsm	Heavyweight 2	15 / 32
Transparency	Transparency	15 / 32

(Requires a finisher)

Media Handling

Trays 1 – 2: 500 sheets each

Sizes: Custom sizes up to A3

Tray 3: 870 sheets; Size: A4

Tray 4: 1,140 sheets; Size: A4

Trays 1 – 4: Weights: 64 to 220 gsm

Bypass Tray (Tray 5): 250 sheets

Sizes: Custom sizes up to SRA3

Maximum guaranteed image size:

print – 317 x 480 mm

copy – 297 x 432 mm

Weights: Up to 300 gsm

Supplies

Smart Kit™ Replaceable Units

Toner Cartridges (1 Cyan, 1 Magenta, 1 Yellow, 2 Black), Drum Cartridges (Cyan, Magenta, Yellow, Black), Charge Corotron, Fuser Module, Waste Toner Container, Staples refill for Convenience Stapler and Finishing options

General Specifications

Electrical

10 amp (220 / 240v)

Dimensions

Smallest Footprint (WxDxH):

1653.6 mm x 921 mm x 1372 mm



Xerox paper and speciality media

Xerox offers the broadest portfolio of Digitally Optimised paper and

specialty media under one brand, making it easy for you to maximise the capabilities of your Xerox DocuColor 240/250 printer-copier and generate new revenue opportunities. Whether you need to create and print a customised newsletter, brochure, transparency, label, ID card, or durable document, Xerox paper and specialty media is your best choice.

*Duty Cycle - Maximum volume capacity expected in any one month. Not expected to be sustained on a regular basis.

** Average Monthly Print Volume - Expected regular monthly print throughput.



Adobe® PostScript® 3™

